

Huntshaw Layout Plan

Overview	Harrison is undergoing a transformation - with large extensions & an Essex-hem make-over, a complementary new garden was required. The existing mature shrubs and a favourable aspect would assist the creation of the new, more colourful outdoor space to complement the new look house.
Brief	The brief for Quercus was to keep the informal curves of the garden. Integration of the indoor & outdoor space is encouraged by the house's L-shaped layout & new bi-fold doors. The natural contours of the garden allow for a new elevated platform from which to view the garden.
Design Considerations	The generally proportioned terraced areas will provide ample relaxation space for even the best attended gatherings. The retaining walls of raised borders offer occasional seating.
Planting	A new L-shaped timber pergola will lead, via long, shallow steps to a wide curved brick path, with long shallow steps provides an alternative route to the terraced areas. Stepping stones will lead through a wide mixed border to a quiet bench. Traditional hand-landscaping materials of red brick & light coloured paving will be absolutely in keeping with the Essex-hem look. The larger areas of paving will be broken up with small brick features (not shown on plan).
Structural	With the garden currently not short of structural planting the plan is to introduce more colour & texture through mainly herbaceous perennial plants & grasses. Generous planting areas around the new terraces will bring seasonal interest & a softening effect.
Structural	A lavender hedge separates terrace from lawn & clipped hedge will screen the dog run from seated users of the part-covered terrace.
Additional Structural	A new tree - maybe Prunus 'Kanzari' will add vertical screening on the left side of the garden as well as colour in spring & autumn. A self-contained water feature sited near the dining terrace & some subtle lighting are possible additions.

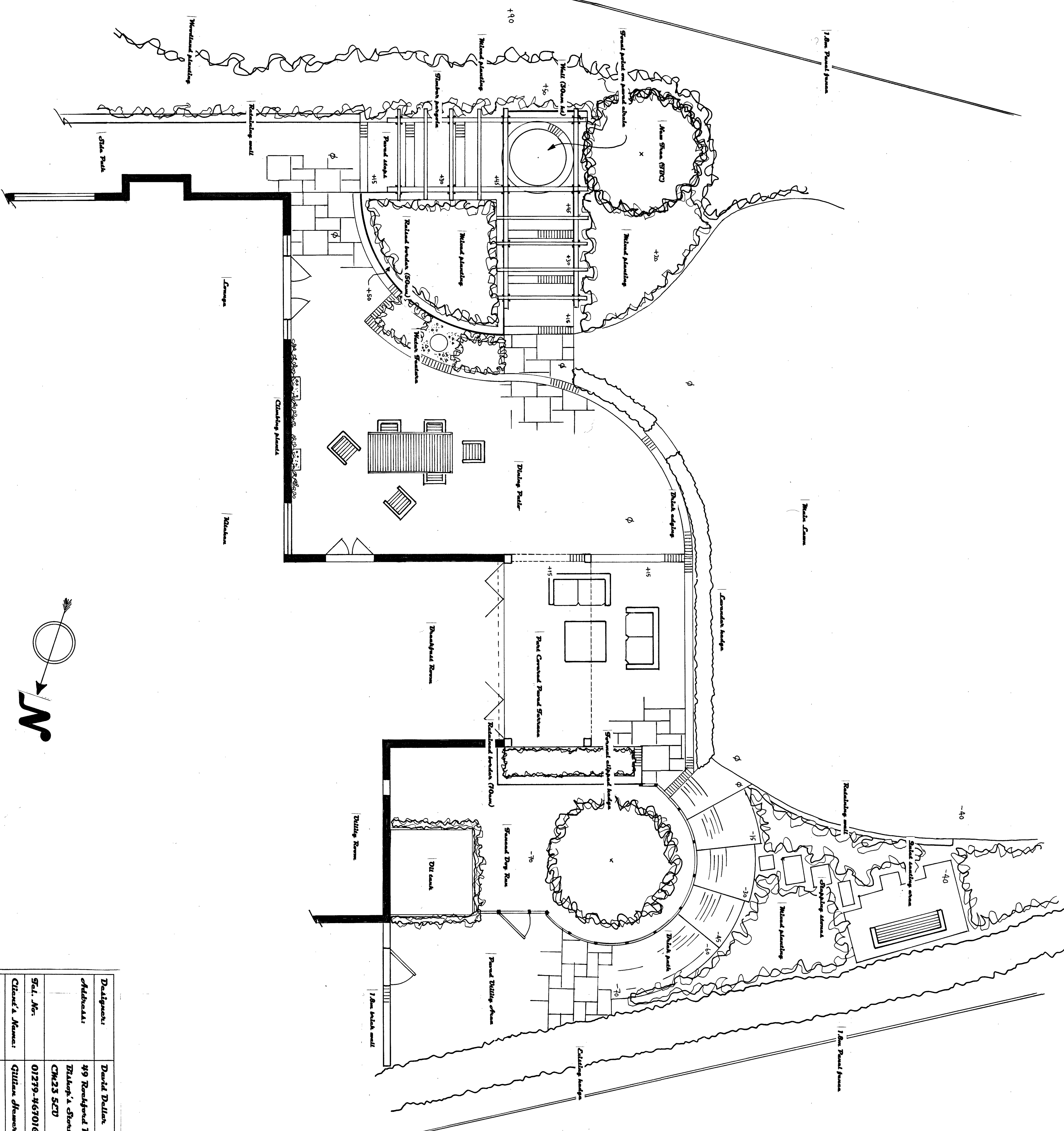

Designer:	David Dolan
Address:	49 Rockford Road, Tilbury's Strand, CM23 5ED
Ref. No.:	01219-463016
Client's Name:	Gillian Hancock & Steve Cooper
Site Title:	Huntshaw, Church Rd., SW5
Drawing Title:	Landscape Plan
Scale:	1 : 50
Date:	6 th September 2012