

8 Pye Gardens (Planting Plan)

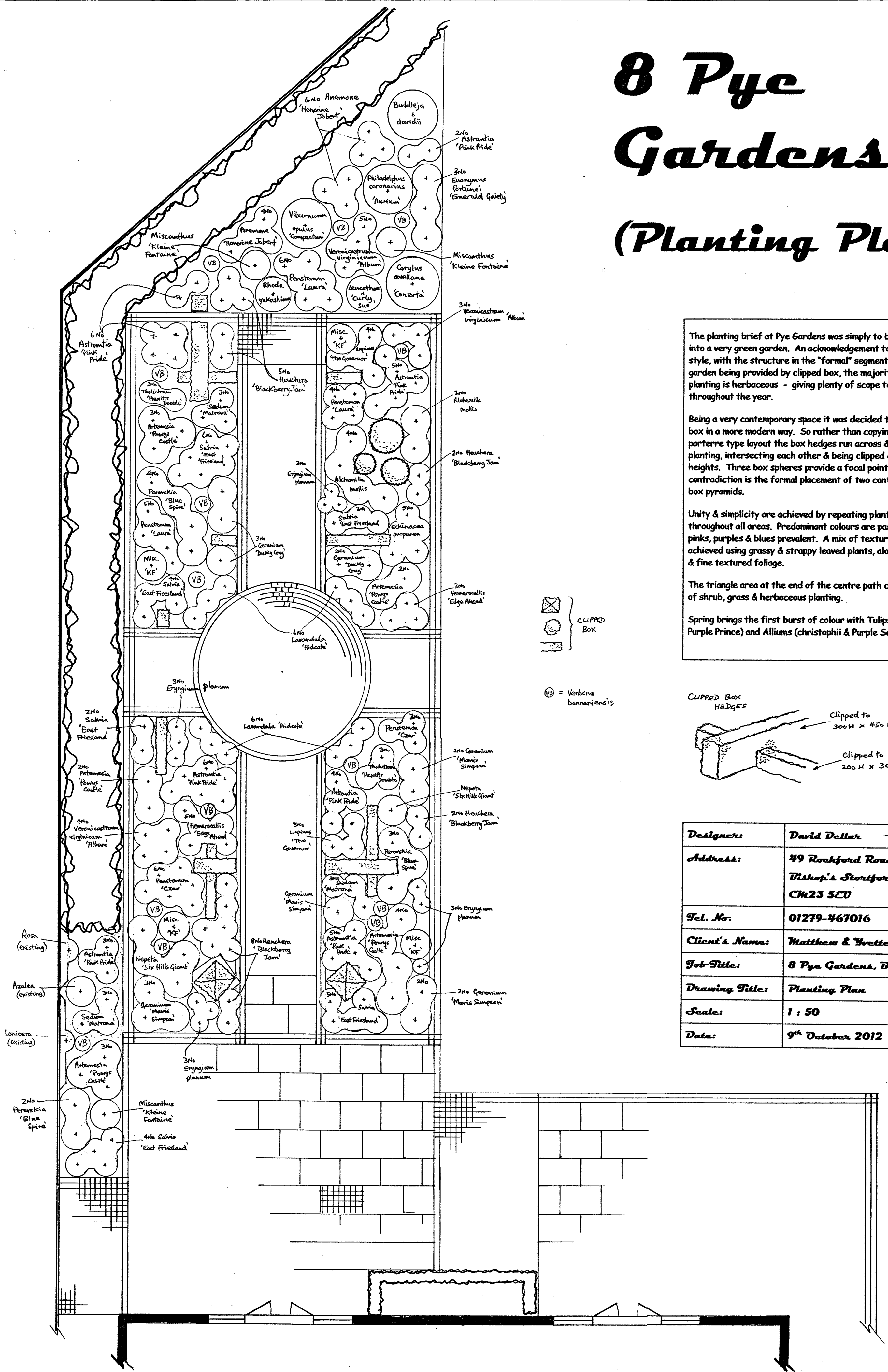

The planting brief at Pye Gardens was simply to bring colour into a very green garden. An acknowledgement to the Dutch style, with the structure in the "formal" segments of the garden being provided by clipped box, the majority of the planting is herbaceous - giving plenty of scope to add colour throughout the year.

Being a very contemporary space it was decided to use clipped box in a more modern way. So rather than copying the formal parterre type layout the box hedges run across & down the planting, intersecting each other & being clipped at two heights. Three box spheres provide a focal point. A final contradiction is the formal placement of two container plant box pyramids.

Unity & simplicity are achieved by repeating plant groups throughout all areas. Predominant colours are pastel, with pinks, purples & blues prevalent. A mix of textures is also achieved using grassy & strappy leaved plants, alongside coars & fine textured foliage.

The triangle area at the end of the centre path contains a mix of shrub, grass & herbaceous planting.

Spring brings the first burst of colour with Tulips (Angelique Purple Prince) and Alliums (christophii & Purple Sensation)

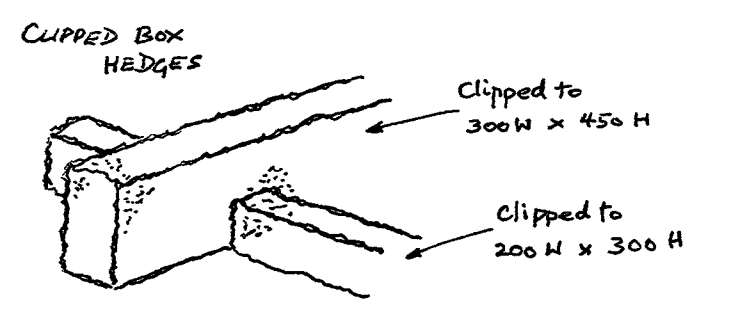
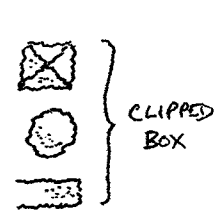

Designer:	David Dellar
Address:	49 Rockford Road, Bishop's Stortford, CM23 5EU
Tel. No.:	01279-467016
Client's Name:	Matthew & Yvette Clarke
Job Title:	8 Pye Gardens, BS
Drawing Title:	Planting Plan
Scale:	1 : 50
Date:	9 th October 2012